

# ESKRIDGE MODEL 50LG

## DOUBLE PLANETARY

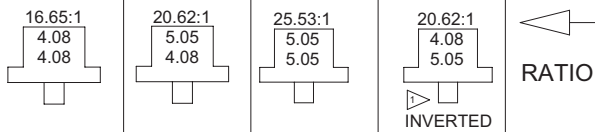

RATIO

EFFECTIVE  
FROM: S/N 38000 11-01-98  
TO: (CURRENT)

PART NUMBER	PART NUMBER	PART NUMBER	PART NUMBER	QTY.	ITEM
50-004-3213					
1 1					
SHAFTS					
50-004-4272L					
50-004-4282L					
50-004-4242L					
50-004-4252L					
50-004-4262L					
50-004-4302L					
50-004-4322L					
50-004-4512L					
COVERS					
50-004-1173					
50-004-1183					
50-004-1233					
50-004-1333					
INPUT GEARS					
85-004-1102	85-004-1062	-	-	1	4
85-004-1122	85-004-1112	-	-	1	4
85-004-1533	-	85-004-1533	-	1	4
85-004-1542	85-004-1422	-	-	1	4
85-004-1582	-	85-004-1582	-	1	4
50-005-2041	-	50-005-2031	-	1	5
50-004-1062	-	50-004-1052	-	1	5A
85-004-1051	-	85-004-1041	-	3	5B
71-004-0121					
01-105-0010					
85-004-1181					
01-153-0210					
85-004-1412	85-004-1092	85-004-1072	-	1	6
50-005-2011	50-005-2021	50-005-2011	-	1	7
50-004-1082	50-004-1072	50-004-1082	-	1	7A
85-004-1031	85-004-1021	85-004-1031	-	3	7B
81-004-0071					
01-105-0410					
81-004-1561					
01-153-0080					
50-004-1023					
50-004-1011					
50-004-1091					
85-016-0601					
01-405-0530					
01-402-0560					
01-102-0140					
01-103-0130					
01-102-0150					
01-103-0140					
01-150-1550					
01-166-0340					
01-207-0070					
01-207-0020					
01-215-0040					
01-216-0070					
01-207-0030					
50-004-1521					
50-004-1452					
50-004-1462					
50-016-1431					
01-402-0720					
01-412-0050					
50-004-1422					
01-160-0630					

CODE	DESCRIPTION
A	"G" BASE- SAE 'C' MNT
C	CUSTOM
D1	2"DIA SHAFT-3/8" KEYWAY
D2	23T 12/24 D.P. SPLINE
D3	2-1/4"DIA SHAFT-1/2" KEYWAY
D4	16T 8/16 D.P. SPLINE
D5	17T 12/24 D.P. SPLINE
D6	17T 12/24 D.P. SPLINE- LONG DROP (3")
D7	2" DIA SHAFT-1/2" KEYWAY
D8	16T 8/16 D.P. SPLINE
C1	SHAFT-CUSTOM
A	COVER-SAE 'A'
B	COVER-SAE 'B' 2-BOLT
C	COVER-SAE 'C' 4-BOLT
K	COVER-SAE 'C' 2-BOLT
2	INPUT GEAR 13T 16/32 DP SPLINE
3	INPUT GEAR SAE 1"-6B SPLINE
4	INPUT GEAR 14T 12/24 DP SPLINE
5	INPUT GEAR 15T 16/32 DP SPLINE
6	INPUT GEAR 1" DIA X .25 KEY
CARRIER ASSEMBLY	
	CARRIER
	PLANET GEAR
	PLANET SHAFT
	PLANET BEARING
	PLANET THRUST WASHER
	ROLL PIN 3/16 X 7/8
	SUN GEAR
CARRIER ASSEMBLY	
	CARRIER
	PLANET GEAR
	PLANET SHAFT
	PLANET BEARING
	PLANET THRUST WASHER
	ROLL PIN 1/8 X 1
	RING GEAR
	CARRIER THRUST WASHER
	INPUT THRUST WASHER
	SEAL KIT (1 SEAL, 2 O-RINGS)
	SEAL-SHAFT
	O-RING
	BEARING CONE (OUTER)
	BEARING CUP (OUTER)
	BEARING CONE (INNER)
	BEARING CUP (INNER)
	HEX CAPSCREW 7/16-20 GR8
	LOCKWASHER 7/16 MED
	PIPE PLUG-MAGNETIC 3/8 NPT-SOC HD
	PIPE PLUG 1/4 NPT-SOC HD
	GREASE FITTING (OPTIONAL)
	AIR VENT 3/8 NPT (OPTIONAL)
	PIPE PLUG (C AND K COVER ONLY) 1/8 NPT
	SHIM(S)
	SPLIT RING (MATCHING HALVES)
	LOCK RING
	HIGH PSI SEAL KIT (INCLUDES 40A, B, C, D)
	O-RING
	SEAL - HIGH PRESSURE
	CARRIER - HIGH PRESSURE SEAL
	HELICAL RETAINING RING

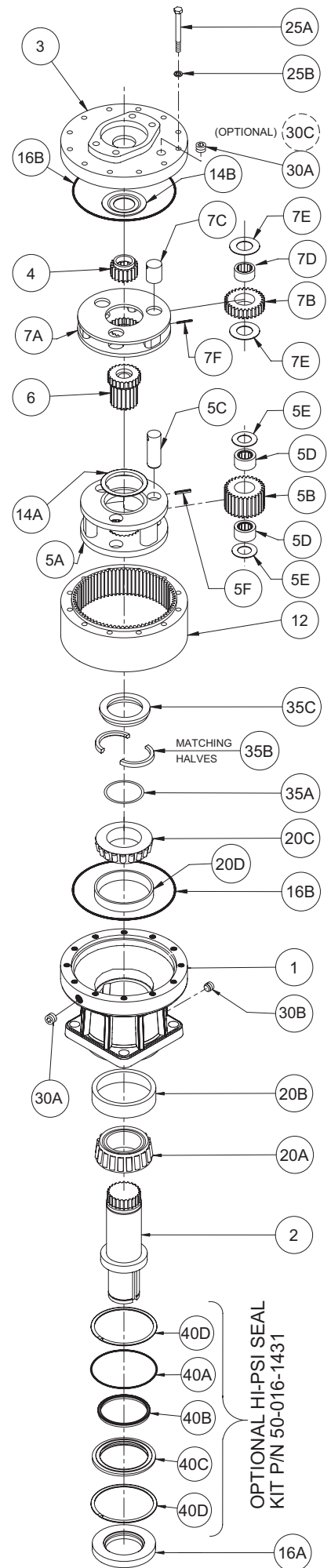

NOTES:  
 1 INVERTED RATIO SUNGEAR IS NOT COUNTERBORED FOR CODE 4 INPUT. MOTOR COMPATIBILITY MUST BE VERIFIED.  
 \* BEARING PRELOAD DETERMINES QUANTITY OF SHIMS.